

a) 2x

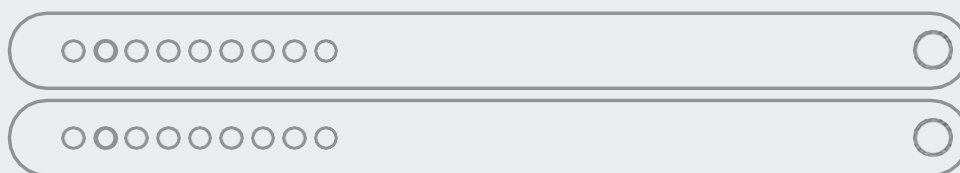

b) 4x



c) 2x



d) 2x



LEGENDA = SYMBOL KEY

- a) 2x STRAP
- b) 4x POST
- c) 2x POSTFASTENER
- d) 2x BUCKLE

1

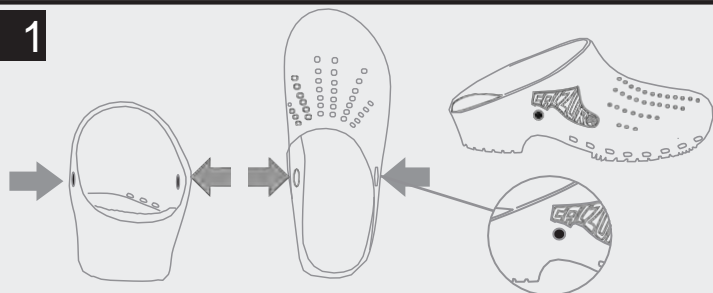

Use a 2mm punching tool to punch a hole in the side of the clog just below the right end of the "Calzuro" logo and above the front of the heel. Repeat this procedure on the other side of the clog, making certain that this hole is symmetrical with the other one.

2

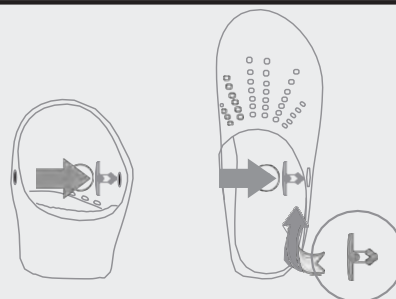

Insert the post as seen in the drawing. Note that the post must be inserted with the flat side facing the inside of the clog.

3

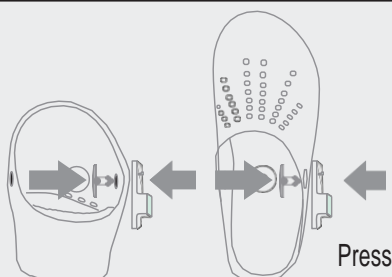

Attach the buckle on the clog on the side with the Calzuro logo by pushing it onto the post until the retention "click" is heard. Point the long end of the buckle toward the front of the clog.

4

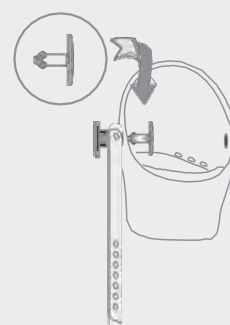

On the opposite side of the clog, insert a post on the inside with the post going out through the hole positioning the flat side facing the inside of the clog. Place the strap onto the post by inserting the post through the large hole on the strap. Make certain for the strap "Calzuro" name is facing the outside (away from the heel).

5

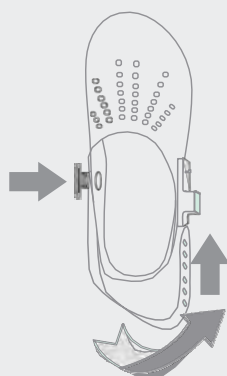

Attach the post fastener onto the post until the retention "click" is heard. Metal pliers can be used to ease this operation.

6

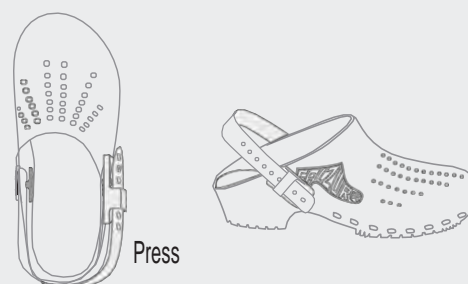

Slide the other end of the strap in the buckle and fasten the buckle onto the hook.